



HARVEY ROBINSON

£180,000

52 Anglian House

Huntingdon, PE29 3PD

## PROPERTY SUMMARY

harveyrobinson Estate Agents are delighted to offer For Sale this well presented Two Double Bedroom Top Floor Apartment. This spacious apartment is located in the heart of Huntingdon's town centre and is within a 5 minute walk of the bus station Train Station which provide access to Cambridge and London Kings Cross in approximately an hour. The apartment is a short distance to the A1 and A14 road links. Huntingdon has many local amenities such as restaurants, shops and bars. The property comprises of an entrance hall, open plan kitchen/lounge/dining area, two double bedrooms bathroom and an allocated parking space. This would make the ideal investment or first time





## GROUND FLOOR 685 sq.ft. (63.7 sq.m.) approx.

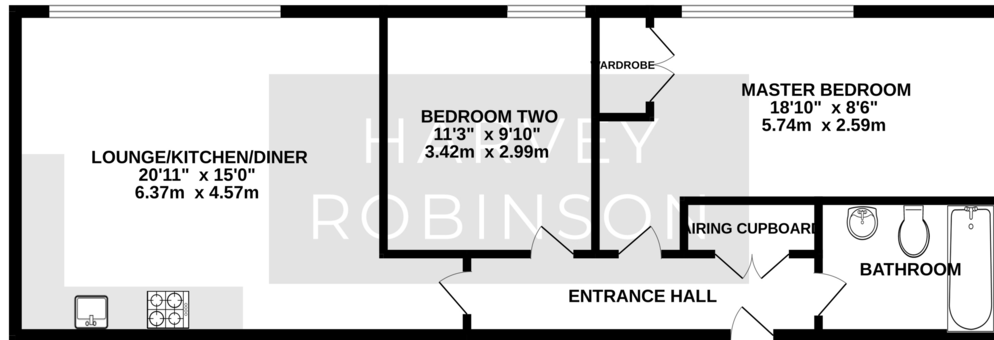

TOTAL FLOOR AREA: 685 sq.ft. (63.7 sq.m.) approx.  
Made with Metropix ©2023

## FAQs

Type Here

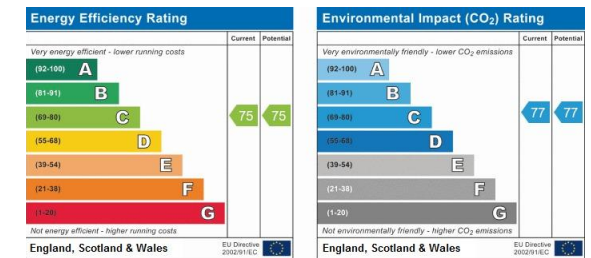

Agents Note: Whilst every care has been taken to prepare these particulars, they are for guidance purposes only. All measurements are approximate and are for general guidance purposes only and whilst every care has been taken to ensure their accuracy, they should not be relied upon and potential buyers/tenants are advised to recheck the measurements

HARVEY ROBINSON

### OFFICE ADDRESS

91 High Street, Huntingdon,  
Cambridgeshire, PE29 3DP

### CONTACT

01480 454040  
huntingdon@harveyrobinson.co.uk  
www.harveyrobinson.co.uk