



HARVEY ROBINSON

£325,000
49 Grasmere
Stukeley Meadows, PE29 6UR

PROPERTY SUMMARY

Harvey Robinson Estate Agents proudly present a stunning Three Bedroom Detached Home in the sought after Stukeley Meadows Estate in Huntingdon. Located at the end of a cul-de-sac, this residence boasts a private driveway for multiple vehicles, single garage, and a rear enclosed garden. Well enhanced by its current owners, the property features an entrance hall, a separate lounge with feature fireplace, a modernised open plan kitchen & dining room on the ground floor. Upstairs, three bedrooms and a family bathroom completes the property.

For more details or to schedule a viewing, reach out to our dedicated team at the Huntingdon Office .

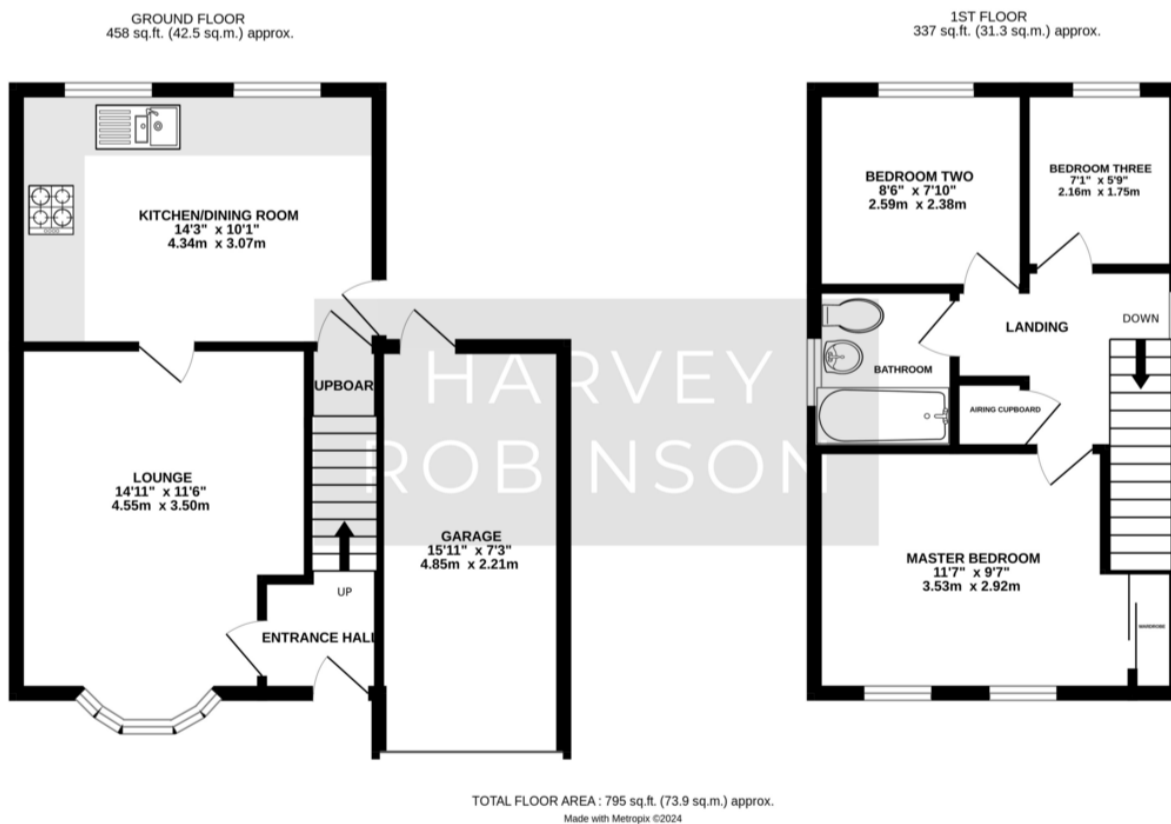

FAQs

Tenure: Freehold

Council Tax Band: C, £169

Vendors Onward Movements: Upsizing locally

Boundary: Back & left hand side

Primary School Catchment: Stukeley Meadows

Secondary School Catchment: St Peters

Age of Boiler: 4 years old

EPC: D with potential for B

Rental Potential: £1450 to £1500pcm

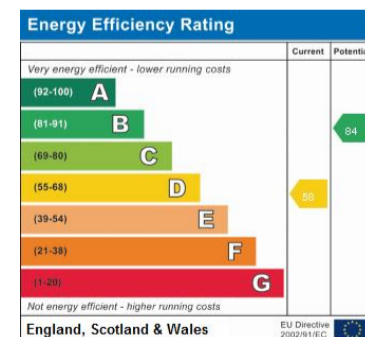

Agents Note: Whilst every care has been taken to prepare these particulars, they are for guidance purposes only. All measurements are approximate and are for general guidance purposes only and whilst every care has been taken to ensure their accuracy, they should not be relied upon and potential buyers/tenants are advised to recheck the measurements

HARVEY ROBINSON

OFFICE ADDRESS

91 High Street, Huntingdon,
Cambridgeshire, PE29 3DP

CONTACT

01480 454040
huntingdon@harveyrobinson.co.uk
www.harveyrobinson.co.uk