



HARVEY ROBINSON

Guide Price

£220,000

Sullivan Court

Biggleswade, SG18 8SQ

We are delighted to offer for sale this well-presented two double bedroom second-floor apartment, perfectly positioned overlooking Central Square within the sought-after Kings Reach development. The accommodation briefly comprises a welcoming entrance hall, a spacious open-plan kitchen/lounge/dining area with a Juliette balcony, two generous double bedrooms, and a modern bathroom. Externally, the property benefits from allocated parking and access to a secure cycle store.





GROUND FLOOR
682 sq.ft. (63.4 sq.m.) approx.

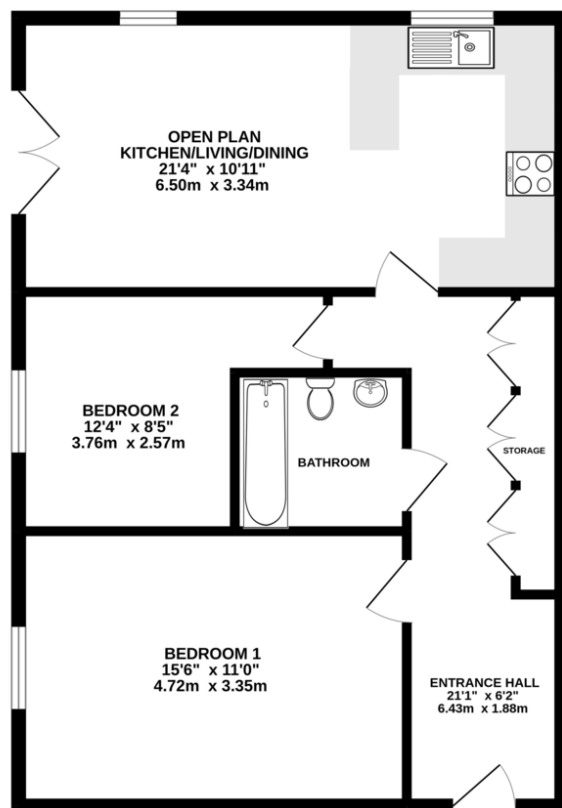

TOTAL FLOOR AREA : 682 sq.ft. (63.4 sq.m.) approx.
Made with Metropix ©2022

FAQs

Tenure: Leasehold
Property Built: 2017
Council Tax Band: B
Lease Length: 91 out of 99 years remaining
Service Charge including Ground Rent: £685.36
Management Company: Amplius
What3Words Location: ///force.unsettled.cared
Water Meter: Yes
Boiler Installed: 2017
EPC Rating: B

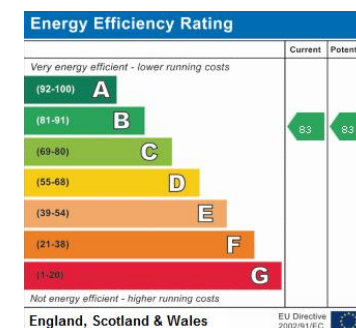

Agents Note: Whilst every care has been taken to prepare these particulars, they are for guidance purposes only. All measurements are approximate and are for general guidance purposes only and whilst every care has been taken to ensure their accuracy, they should not be relied upon and potential buyers/tenants are advised to recheck the measurements

HARVEY ROBINSON

OFFICE ADDRESS

5 Purcell Place, Sullivan Court,
Biggleswade, Bedfordshire,
SG18 8SX

CONTACT

01767 660770
biggleswade@harveyrobinson.co.uk
www.harveyrobinson.co.uk