

A two-story semi-detached house with a brick and timber frame exterior. The house has a dark brown roof and a paved driveway. In the foreground, there are several blue and green bins with 'HDC' logos. The house is surrounded by a garden and a fence. A rainbow flag is visible in the background. The sky is blue with some clouds.

HARVEY ROBINSON

Offers In Region Of
£340,000
Herne Road
Ramsey, PE26 2TB

PROPERTY SUMMARY

Harvey Robinson Estate Agents in Huntingdon are delighted to be offering For Sale this well presented Four Double Bedroom Detached Home in the popular rural village of Ramsey St Marys located 3 miles North West of Ramsey. This beautiful home is offered with no onward chain and offers an abundance of benefits including a refitted kitchen with opening to dining room creating 22ft of stunning space, separate 22ft lounge with French doors leading to a landscaped garden with kennels and converted garage offering annex potential, home office or studio, off road parking to the front, four double bedrooms and a refitted shower room to the ground floor and refitted bathroom to the first floor. This property is a must see to truly appreciate. For further information, please contact our Huntingdon office.





GROUND FLOOR
578 sq.ft. (53.7 sq.m.) approx.

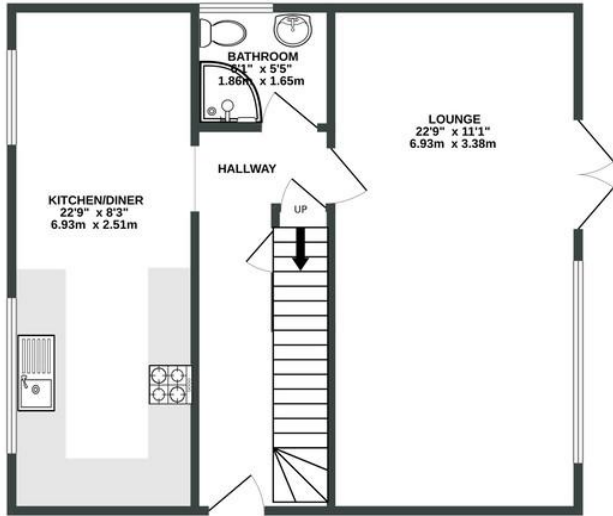

1ST FLOOR
578 sq.ft. (53.7 sq.m.) approx.

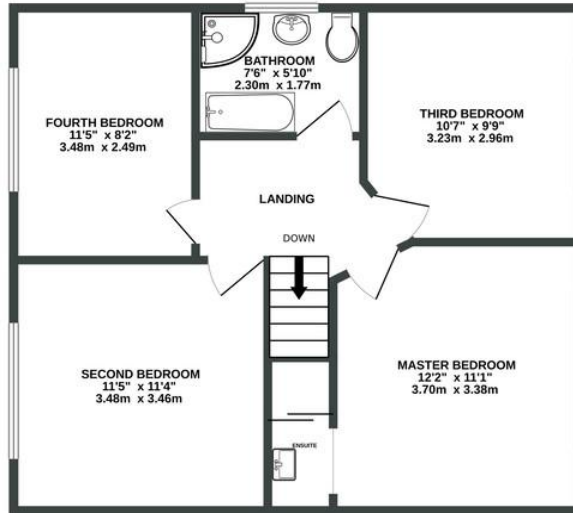

TOTAL FLOOR AREA : 1156 sq.ft. (107.4 sq.m.) approx.
Made with Metropix ©2023

FAQs

Tenure: Freehold
Council Tax Band: C
Vendors Onward Movements: No chain
Primary School Catchment: The Ashbeach
Secondary School Catchment: Ramsey Abbey

Energy Efficiency Rating		
	Current	Potential
Very energy efficient - lower running costs		
(92-100) A		
(81-91) B		
(69-80) C		73
(55-68) D	62	

Agents Note: Whilst every care has been taken to prepare these particulars, they are for guidance purposes only. All measurements are approximate and are for general guidance purposes only and whilst every care has been taken to ensure their accuracy, they should not be relied upon and potential buyers/tenants are advised to recheck the measurements

HARVEY ROBINSON

OFFICE ADDRESS

91 High Street, Huntingdon,
Cambridgeshire, PE29 3DP

CONTACT

01480 454040
huntingdon@harveyrobinson.co.uk
www.harveyrobinson.co.uk