



HARVEY ROBINSON

£225,000

Corfe Place

Eynesbury, PE19 2RS



## PROPERTY SUMMARY

Harvey Robinson estate agents in St Neots are delighted to offer for sale this two bedroom mid-terraced home located at the end of a small cul-de-sac in the popular area of Eynesbury. The property would benefit from updating throughout and comprises of an entrance porch leading through to a bright lounge, a kitchen diner with double UPVC doors leading out into the garden. Upstairs you will find the primary bedroom with built in storage, a further bedroom and a bathroom which has been modernised. Outside, the property further benefits from an enclosed rear garden and an allocated parking space directly opposite.

To arrange a viewing, please contact the St Neots team on 01480 454040 option 2.







GROUND FLOOR  
269 sq.ft. (25.0 sq.m.) approx.

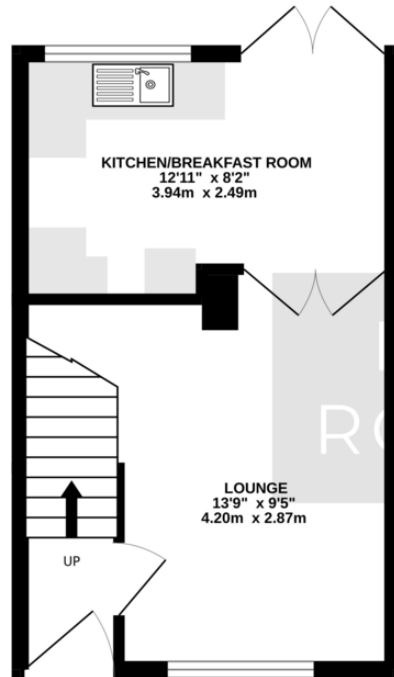

1ST FLOOR  
270 sq.ft. (25.1 sq.m.) approx.

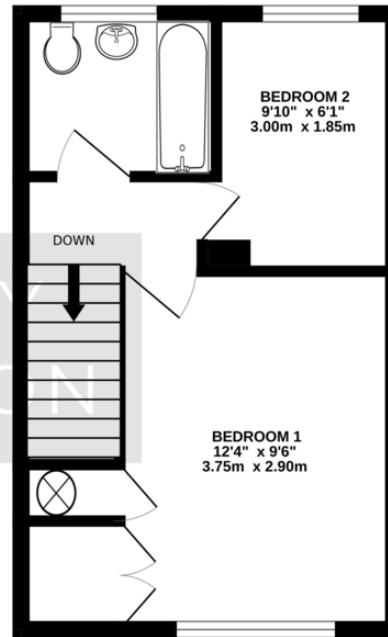

TOTAL FLOOR AREA: 539 sq.ft. (50.0 sq.m.) approx.  
Made with Metropix ©2024

## FAQs

Tenure: Freehold

Age of property: 1985

Council tax: B

Rear Garden Aspect: East

Heating System: Warm Air Heating

Postcode for SatNav: PE19 2RS

What3Words location: ///pampering.decoded.quick

Please note we have not tested any apparatus, fixtures, fittings, or services. Interested parties must undertake their own investigation into the working order of these items. All measurements are approximate, and photographs provided for guidance only.

Need to sell your property? Please contact us to arrange your free, no obligation Market Appraisal.

For independent whole of market mortgage advice please call the team to book your appointment.

View all our properties at [harveyrobinson.co.uk](http://harveyrobinson.co.uk)

Rated 5.0 on Google Reviews

Rated Excellent in Best Estate Agent Guide

Gold Award - allagents

EPC TO FOLLOW

Agents Note: Whilst every care has been taken to prepare these particulars, they are for guidance purposes only. All measurements are approximate and are for general guidance purposes only and whilst every care has been taken to ensure their accuracy, they should not be relied upon and potential buyers/tenants are advised to recheck the measurements

HARVEY ROBINSON

### OFFICE ADDRESS

22 Market Square, St Neots,  
Cambridgeshire, PE19 2AF

### CONTACT

01480 454040

[stneots@harveyrobinson.co.uk](mailto:stneots@harveyrobinson.co.uk)

[www.harveyrobinson.co.uk](http://www.harveyrobinson.co.uk)