



HARVEY ROBINSON

£170,000

Cheere Way

Papworth Everard, CB23 3NZ

PROPERTY SUMMARY

Harvey Robinson estate agents in St Neots are delighted to offer for sale this two bedroom first floor apartment in the desirable village of Papworth Everard. The property benefits from an entrance hall, an open plan lounge/kitchen/dining space allowing for ample living space, two bedrooms and a bathroom. Outside the property there is an allocated parking space and access to green spaces. The property would make an ideal first time purchase or buy to let investment.

Viewing is highly recommended, to book an appointment please contact the St Neots team on 01480 454040 option 2.

2



1



1





GROUND FLOOR
583 sq.ft. (54.2 sq.m.) approx.

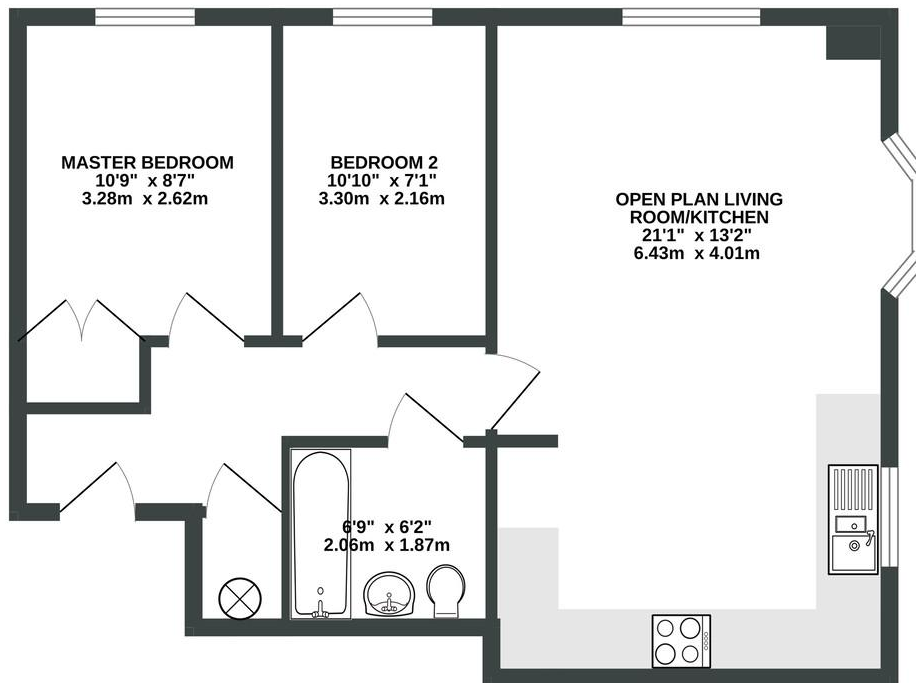

TOTAL FLOOR AREA : 583 sq.ft. (54.2 sq.m.) approx.
Made with Metropix ©2024

FAQs

Postcode for SatNav: CB23 3NZ
What3words location: ///surprise.suits.steps
Council tax: B
Property built: 2002
Vendors onward movements: Relocating
Water meter: Yes

Lease: 125 years from new
Ground rent: £181 per annum
Service charge: £1,653.40 per annum

Need to sell your property? Please contact us to arrange your free, no obligation Market Appraisal.

For independent whole of market mortgage advice please call the team to book your appointment.

View all our properties at harveyrobinson.co.uk

Rated 5.0 on Google Reviews
Rated Excellent in Best Estate Agent Guide
Gold Award - allagents

Energy Efficiency Rating		
	Current	Potential
Very energy efficient - lower running costs		
(92-100) A		
(81-91) B	83	83
(69-80) C		
(55-68) D		
(39-54) E		
(21-38) F		
(1-20) G		
Not energy efficient - higher running costs		
England, Scotland & Wales	EU Directive 2002/91/EC	

Agents Note: Whilst every care has been taken to prepare these particulars, they are for guidance purposes only. All measurements are approximate and are for general guidance purposes only and whilst every care has been taken to ensure their accuracy, they should not be relied upon and potential buyers/tenants are advised to recheck the measurements

HARVEY ROBINSON

OFFICE ADDRESS

22 Market Square, St Neots,
Cambridgeshire, PE19 2AF

CONTACT

01480 454040
stneots@harveyrobinson.co.uk
www.harveyrobinson.co.uk