



HARVEY ROBINSON

£270,000

Cumberland Way

Eynesbury, PE19 2RQ

PROPERTY SUMMARY

Harvey Robinson Estate Agents in St Neots are pleased to offer for sale this three bedroom end of terrace home, located within the popular Parklands estate. The property has recently been modernised, and benefits from a brand new kitchen and bathroom, redecoration and new flooring throughout.

The ground floor accommodation includes an entrance hall, kitchen, spacious lounge with dining area and access to the rear garden. Upstairs there are two double bedrooms, a single bedroom and a bathroom.

Externally, the property benefits from an enclosed rear garden, an allocated parking space to the front, and a garage en-bloc. The property is well situated with easy access to the town centre, amenities, schools and scenic walks in the nearby conservation area 'Pocket Park'.





GROUND FLOOR
358 sq.ft. (33.2 sq.m.) approx.

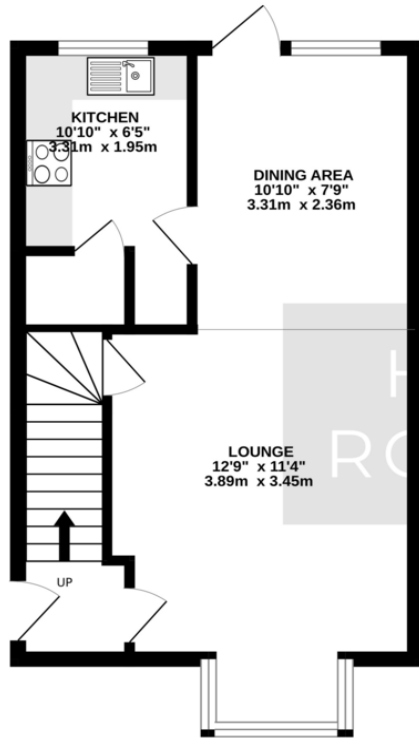

1ST FLOOR
344 sq.ft. (32.0 sq.m.) approx.

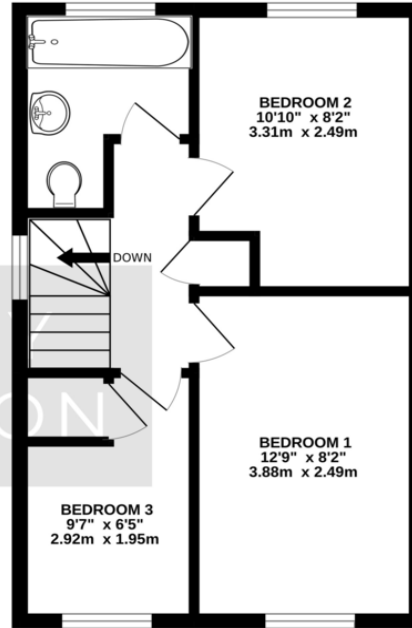

TOTAL FLOOR AREA: 702 sq.ft. (65.2 sq.m.) approx.
Made with Metropix ©2024

FAQs

Council Tax: Band B

Tenure: Freehold

Onward Movements: Vacant, No Chain

Primary School Catchment: Middlefield

Secondary School Catchment: Ernulf

Boiler: Approx 5 Years Old

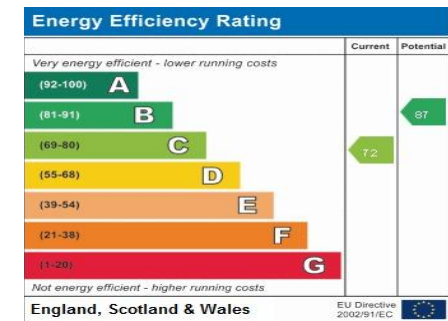

Agents Note: Whilst every care has been taken to prepare these particulars, they are for guidance purposes only. All measurements are approximate and are for general guidance purposes only and whilst every care has been taken to ensure their accuracy, they should not be relied upon and potential buyers/tenants are advised to recheck the measurements

HARVEY ROBINSON

OFFICE ADDRESS

22 Market Square, St Neots,
Cambridgeshire, PE19 2AF

CONTACT

01480 454040
stneots@harveyrobinson.co.uk
www.harveyrobinson.co.uk