



HARVEY ROBINSON

Offers In Excess Of
£280,000

Cornelius Mews, Market Square
St Neots, PE19 2AF

PROPERTY SUMMARY

Harvey Robinson estate agents in St Neots are delighted to offer for-sale this stunning two-bedroom mews style home located just off St Neots market square within a small, gated development. The market square is approaching the end of a £15 million regeneration which will enhance the town centre and makes this the ideal location to purchase a new home. The accommodation comprises a large open plan lounge/kitchen area which is fitted with a high specification kitchen with a large central island and breakfast bar, an inner hall, and a downstairs cloakroom. The first floor has two bedrooms and a modern bathroom. Outside there is a large communal courtyard where there is a brick built storage shed. Please contact our St Neots branch to arrange a viewing.





GROUND FLOOR
309 sq.ft. (28.7 sq.m.) approx.

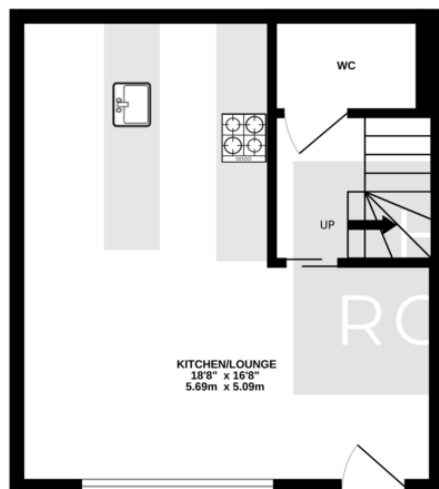

1ST FLOOR
305 sq.ft. (28.4 sq.m.) approx.

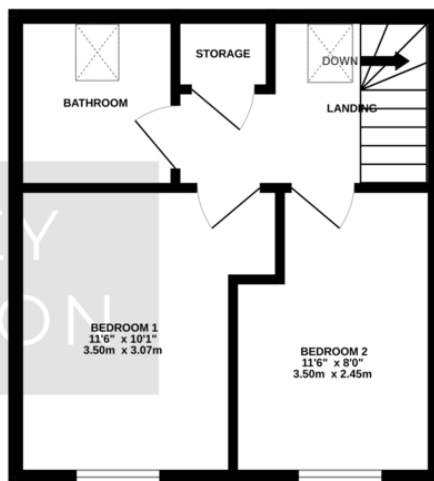

TOTAL FLOOR AREA : 615 sq.ft. (57.1 sq.m.) approx.
Made with Metropix ©2024

FAQs

Postcode for SatNav: PE19 2AF
 Whhat3Words Location:
 ///mealtime.loving.valley
 Council tax: C
 When was the property built: 2020
 How long has the owner lived here:
 Since new
 Water meter: Yes
 Loft: Boarded with light fitted
 Service charge: £236 per annum

Energy Efficiency Rating		
	Current	Potential
Very energy efficient - lower running costs		
(92+) A		97
(81-91) B	83	
(69-80) C		
(55-68) D		
(39-54) E		
(21-38) F		
(1-20) G		
Not energy efficient - higher running costs		
England & Wales		EU Directive 2002/91/EC
WWW.EPC4U.COM		

Agents Note: Whilst every care has been taken to prepare these particulars, they are for guidance purposes only. All measurements are approximate and are for general guidance purposes only and whilst every care has been taken to ensure their accuracy, they should not be relied upon and potential buyers/tenants are advised to recheck the measurements

HARVEY ROBINSON

OFFICE ADDRESS

22 Market Square, St Neots,
Cambridgeshire, PE19 2AF

CONTACT

01480 454040
 stneots@harveyrobinson.co.uk
 www.harveyrobinson.co.uk