



HARVEY ROBINSON

£650,000

Dairy Lane

Papworth Everard, CB23 3AG



## PROPERTY SUMMARY

Harvey Robinson estate agents in St Neots are delighted to be marketing this spacious six-bedroom detached family home offering versatile accommodation over three floors. The property is located on the edge of this popular village with an outlook on to a small, wooded area and fields beyond. The accommodation comprises of an entrance hall, cloakroom, bay fronted study, a 19ft lounge, a 21ft kitchen/diner and a utility room to the ground floor. To the first floor there are four double bedrooms including a master bedroom with dressing room and en-suite, and a family bathroom. To the second floor there is a large landing that can be utilised as an additional study space, there are two further double bedrooms one of which has an en-suite. Outside there is off road parking, a single garage, and an enclosed garden.







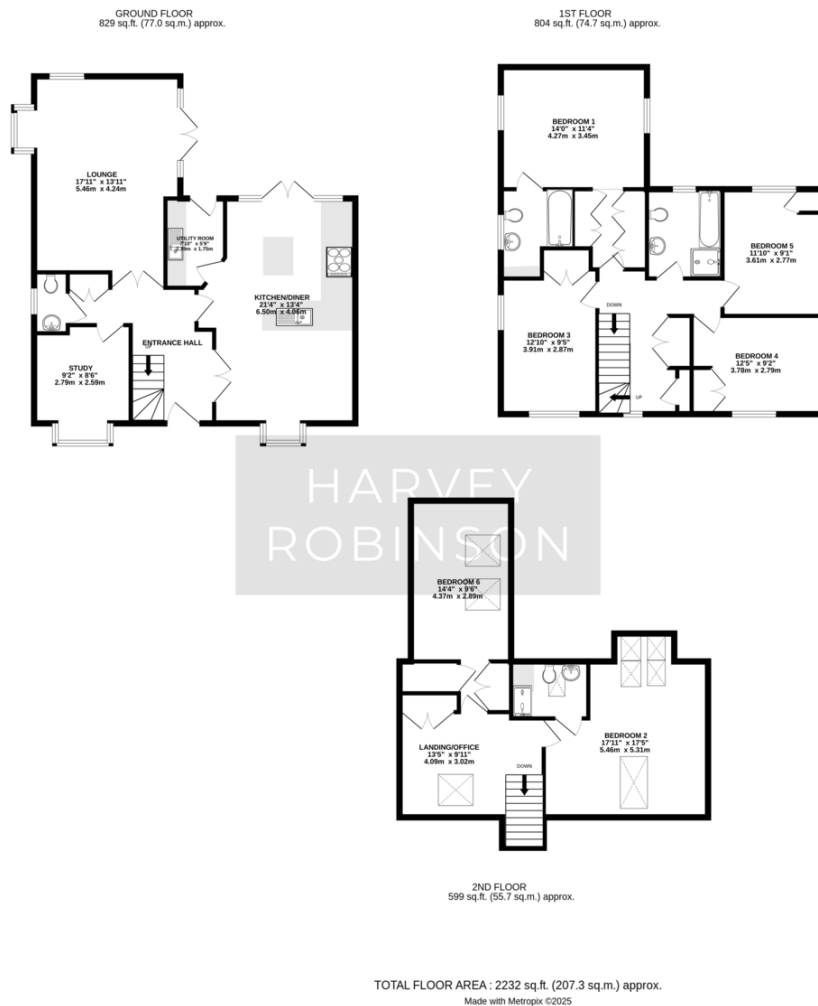

## FAQs

Postcode for SatNav: CB23 3AG

What3Words Location: ///retract.smart.breached

Council tax: G

When was the property built: 2012

How long have the owners lived here: Since 2016

Vendors onward movements: Moving out of area for work reasons

Rear boundary responsibilities: Left, right & rear

Primary catchment: Papworth

Secondary catchment: Swavesey village college

Boiler installed: 2012, last serviced in August 2024

Estate service charge: The most recent bill the owners received was for £118.86 for 6 months

Energy Efficiency Rating		
	Current	Potential
Very energy efficient - lower running costs		
(92+) A		
(81-91) B		
(69-80) C		
(55-68) D		
(39-54) E		
(21-38) F		
(1-20) G		
Not energy efficient - higher running costs		
England & Wales	EU Directive 2002/91/EC	
WWW.EPC4U.COM		

Agents Note: Whilst every care has been taken to prepare these particulars, they are for guidance purposes only. All measurements are approximate and are for general guidance purposes only and whilst every care has been taken to ensure their accuracy, they should not be relied upon and potential buyers/tenants are advised to recheck the measurements

HARVEY ROBINSON

### OFFICE ADDRESS

22 Market Square, St Neots,  
Cambridgeshire, PE19 2AF

### CONTACT

01480 454040  
stneots@harveyrobinson.co.uk  
www.harveyrobinson.co.uk