



HARVEY ROBINSON

Offers In Excess Of
£250,000
15 Field Walk
Godmanchester, PE29 2DL

Harvey Robinson Estate Agents in Huntingdon are delighted to present for sale this beautifully extended and improved three-bedroom family home, ideally situated in the sought-after town of Godmanchester.

This spacious and well-presented property offers a practical and stylish layout, and briefly comprises Entrance Hall, Cloakroom, Lounge, Dining Room, Modern Kitchen, Three Generously Sized Bedrooms, Family Bathroom, Enclosed Front and Rear Gardens, Off-Road Parking Located close to local amenities, schools, and excellent transport links, this home is perfect for families or those looking to upsize.

□ To arrange a viewing or for more information, please contact Harvey Robinson Estate Agents in Huntingdon today.





GROUND FLOOR
536 sq.ft. (49.8 sq.m.) approx.

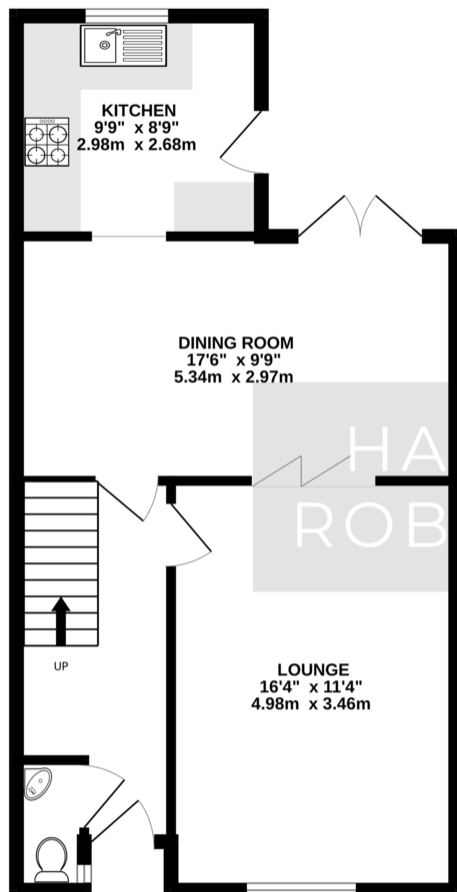

1ST FLOOR
457 sq.ft. (42.4 sq.m.) approx.

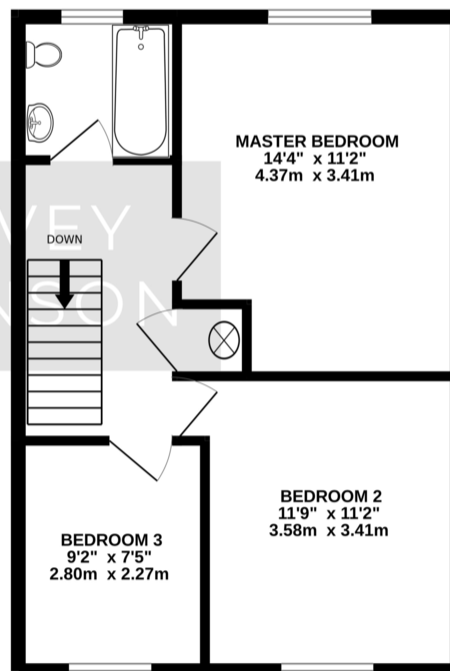

FAQs

Council Tax Band: B
Extended: 1989
Management Company: Muir Housing
Service Charge £124 per year
Current Owner: Owned since 1989
Onward Movement: No Onward Chain
With Back to Property: Boundary is Back and Right
Primary School Catchment: Community Academy
Secondary School Catchment: Hinchbrook
Water Meter: Yes
Heating: Electric
WhatThreeWords: ///canny.media.detonated
Please note we have not tested any apparatus, fixtures, fittings, or services. Interested parties must undertake their own investigation into the working order of these items. All measurements are approximate, and photographs provided for guidance only.

Score	Energy rating	Current	Potential
92+	A		
81-91	B		86 B
69-80	C		
55-68	D	60 D	
39-54	E		
21-38	F		

Agents Note: Whilst every care has been taken to prepare these particulars, they are for guidance purposes only. All measurements are approximate and are for general guidance purposes only and whilst every care has been taken to ensure their accuracy, they should not be relied upon and potential buyers/tenants are advised to recheck the measurements

HARVEY ROBINSON

OFFICE ADDRESS

91 High Street, Huntingdon,
Cambridgeshire, PE29 3DP

CONTACT

01480 454040
huntingdon@harveyrobinson.co.uk
www.harveyrobinson.co.uk