



HARVEY ROBINSON

Offers In Excess Of

£180,000

66 Lindisfarne Close

Eynesbury, PE19 2UU

PROPERTY SUMMARY

Harvey Robinson estate agents in St Neots are delighted to be marketing this two-bedroom cluster home located in Eynesbury. The property is offered for-sale with no onward chain and would benefit from some cosmetic updating but has been priced to reflect this. The property is positioned in a traffic free location and overlooks a green area to the front, internally there is an entrance hall, fitted kitchen, bay fronted lounge/diner, two bedrooms, and a shower room. Outside there is an allocated parking space, a brick-built storage cupboard and a small garden area. Please contact our St Neots branch to arrange a viewing





FAQs

Type Here

1ST FLOOR
269 sq.ft. (25.0 sq.m.) approx.

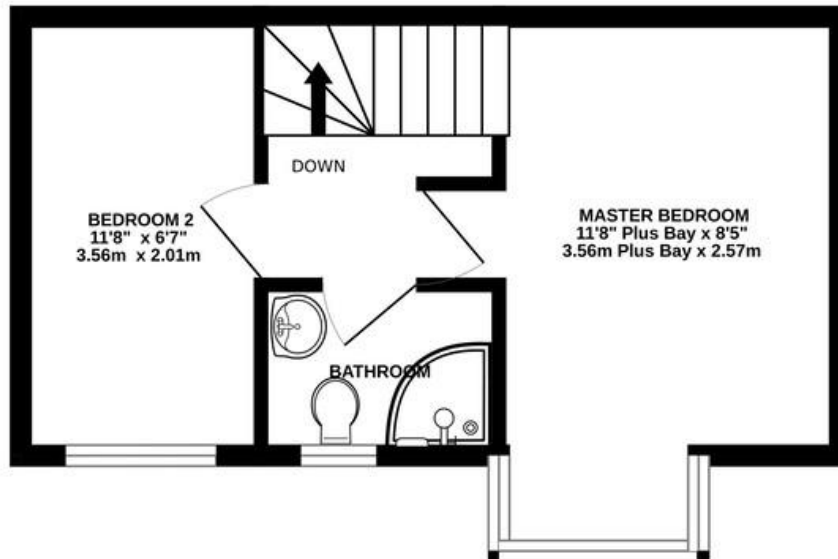

TOTAL FLOOR AREA : 538 sq.ft. (50.0 sq.m.) approx.

Made with Metropix ©2025

HARVEY
ROBINSON

GROUND FLOOR

Score	Energy rating	Current	Potential
92+	A		
81-91	B		87 B
69-80	C	71 C	
55-68	D		
39-54	E		
21-38	F		

Agents Note: Whilst every care has been taken to prepare these particulars, they are for guidance purposes only. All measurements are approximate and are for general guidance purposes only and whilst every care has been taken to ensure their accuracy, they should not be relied upon and potential buyers/tenants are advised to recheck the measurements

HARVEY ROBINSON

OFFICE ADDRESS

22 Market Square, St Neots,
Cambridgeshire, PE19 2AF

CONTACT

01480 454040
stneots@harveyrobinson.co.uk
www.harveyrobinson.co.uk