



HARVEY ROBINSON

Offers In Excess Of
£300,000
7 Ambury Hill
Huntingdon, PE29 1JQ

PROPERTY SUMMARY

Harvey Robinson Estate Agents are delighted to present this extended three-bedroom semi-detached home in the heart of Huntingdon. Built in the 1940s, this well-constructed property has been thoughtfully extended, offering spacious and versatile living.

The ground floor boasts a spacious 25ft open-plan kitchen/diner/family room, perfect for modern living and entertaining. Additionally, you'll find a separate utility room, a convenient wet room, and a generously sized lounge, providing ample space for relaxation.

Upstairs, the home features three well-proportioned bedrooms, including two spacious doubles, and a four-piece family bathroom.

Situated on a desirable corner plot, the property benefits from a generous outdoor space, ample parking, and a garage. Offered with no onward chain, this property is a must see to appreciate the space and accommodation throughout.

For more details or to arrange a viewing, please contact our Huntingdon office today!





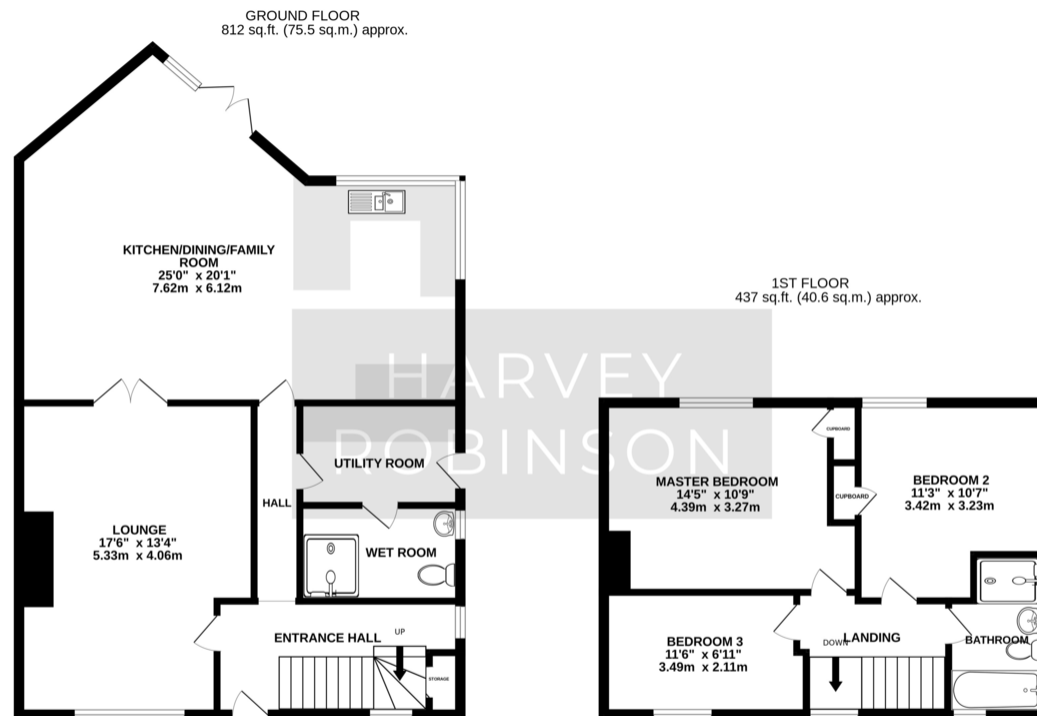

FAQs

Tenure: Freehold

Council Tax Band: C

Vendors Onward Movements: No chain

%epcGraph_c_1_280%

Agents Note: Whilst every care has been taken to prepare these particulars, they are for guidance purposes only. All measurements are approximate and are for general guidance purposes only and whilst every care has been taken to ensure their accuracy, they should not be relied upon and potential buyers/tenants are advised to recheck the measurements

HARVEY ROBINSON

OFFICE ADDRESS

91 High Street, Huntingdon,
Cambridgeshire, PE29 3DP

CONTACT

01480 454040
huntingdon@harveyrobinson.co.uk
www.harveyrobinson.co.uk