



HARVEY ROBINSON

Offers In Excess Of

£190,000

8 Skipper Way

Little Paxton, PE19 6LQ



## PROPERTY SUMMARY

Located in the sought after village of Little Paxton and being a short journey away from St Neots town, the property comprises of an entrance hall, open plan living, kitchen and dining space which benefits from a Juliet balcony with views across the river. You will also find two bedrooms, one of which has an en-suite and built in storage, finishing off with the spacious family bathroom.







GROUND FLOOR  
786 sq.ft. (73.0 sq.m.) approx.

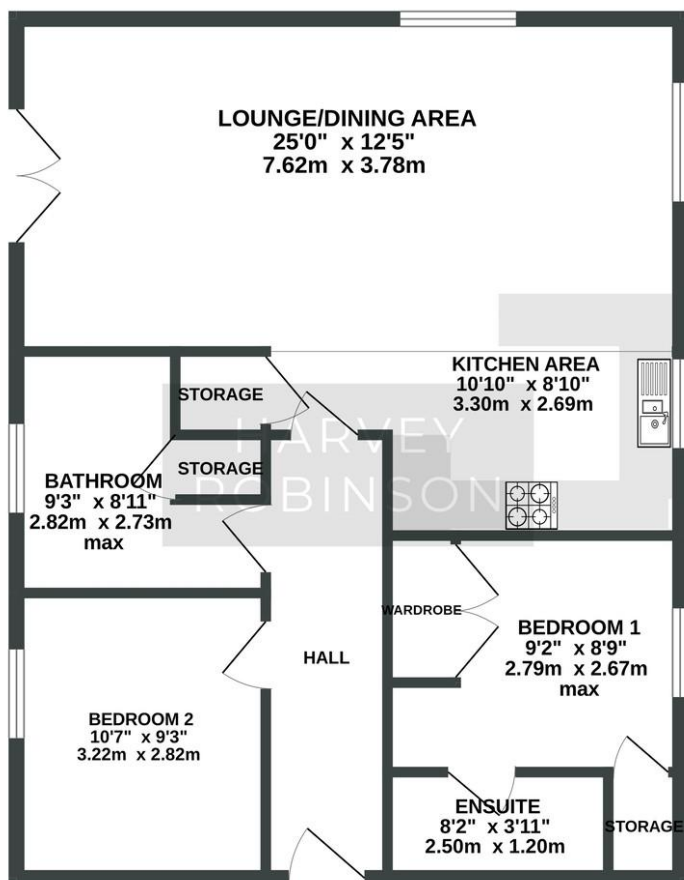

TOTAL FLOOR AREA: 786 sq.ft. (73.0 sq.m.) approx.  
Made with Metropix ©2025

## FAQs

Tenure: Leasehold

EPC: C

Property Built: 2007

Onward Movements: No Onward Chain

Council Tax: Band C

Leasehold Information:

Lease Length: 107 years remaining out of 125

Service Charge & Ground Rent: Approx £3,000 total per annum



Agents Note: Whilst every care has been taken to prepare these particulars, they are for guidance purposes only. All measurements are approximate and are for general guidance purposes only and whilst every care has been taken to ensure their accuracy, they should not be relied upon and potential buyers/tenants are advised to recheck the measurements

HARVEY ROBINSON

### OFFICE ADDRESS

22 Market Square, St Neots,  
Cambridgeshire, PE19 2AF

### CONTACT

01480 454040  
stneots@harveyrobinson.co.uk  
www.harveyrobinson.co.uk