



HARVEY ROBINSON

£185,000
Eayre Court
St. Neots, PE19 1QZ

PROPERTY SUMMARY

Harvey Robinson estate agents in St Neots are excited to be marketing this delightful one double bedroom coach house, perfectly positioned within walking distance to the local station and a range of nearby amenities.





FAQs

Tenure: Freehold

EPC: C

Property Built: 1988

Onward Movements: No Onward Chain

Council Tax: Band A

Loft: Partly Boarded

Water Meter: Yes

Heating: Electric

Please note we have not tested any apparatus, fixtures, fittings, or services. Interested parties must undertake their own investigation into the working order of these items. All measurements are approximate, and photographs provided for guidance only.

Need to sell your property? Please contact us to arrange your free, no obligation Market Appraisal.

For independent whole of market mortgage advice please call the team to book your appointment.

View all our properties at harveyrobinson.co.uk

Rated Exceptional in Best Estate Agent Guide 2024
British Property Awards 2023 & 2024 – Gold Winner

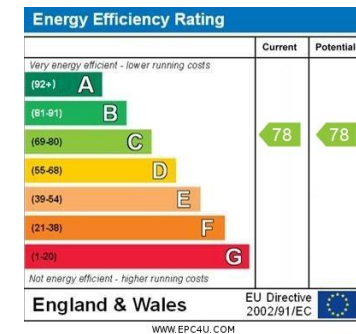

Agents Note: Whilst every care has been taken to prepare these particulars, they are for guidance purposes only. All measurements are approximate and are for general guidance purposes only and whilst every care has been taken to ensure their accuracy, they should not be relied upon and potential buyers/tenants are advised to recheck the measurements

GROUND FLOOR
531 sq.ft. (49.3 sq.m.) approx.

1ST FLOOR
175 sq.ft. (16.3 sq.m.) approx.

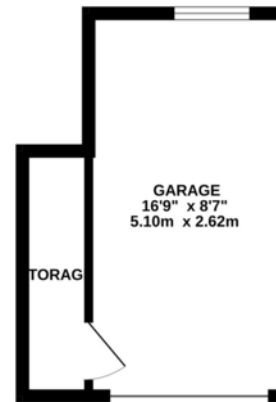
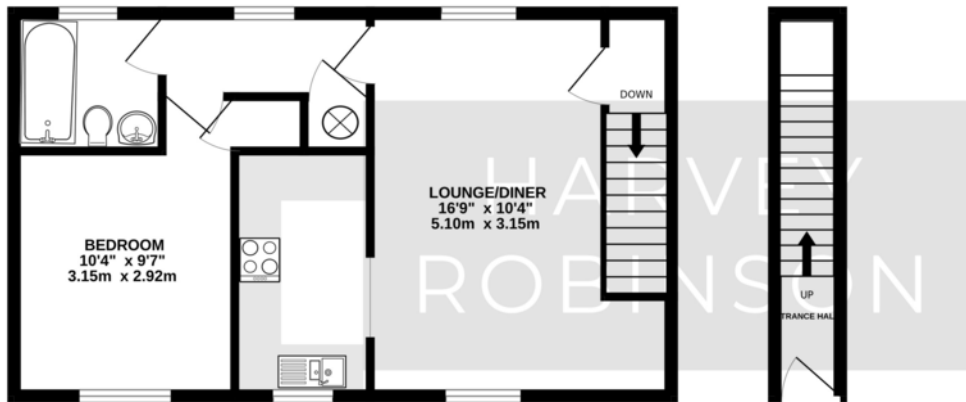

TOTAL FLOOR AREA: 706 sq.ft. (65.6 sq.m.) approx.
Made with Metropix ©2025

HARVEY ROBINSON

OFFICE ADDRESS

22 Market Square, St Neots,
Cambridgeshire, PE19 2AF

CONTACT

01480 454040
stneots@harveyrobinson.co.uk
www.harveyrobinson.co.uk