



HARVEY ROBINSON

Offers In Excess Of  
**£375,000**  
Kym Road  
Eaton Ford, PE19 7JT



## PROPERTY SUMMARY

Harvey Robinson estate agents in St Neots are delighted to be marketing, with no onward chain, this three bedroom, extended detached home located in the sought-after area of Eaton Ford. The accommodation comprises of an entrance porch, study, cloakroom, utility room, lounge, dining room, conservatory and kitchen to the ground floor. To the first floor there are three bedrooms, and a shower room. Outside the property there is a block paved driveway to the front, to the rear there is an enclosed garden. Please contact our St Neots branch to arrange a viewing.







GROUND FLOOR  
650 sq.ft. (60.4 sq.m.) approx.

1ST FLOOR  
426 sq.ft. (39.6 sq.m.) approx.

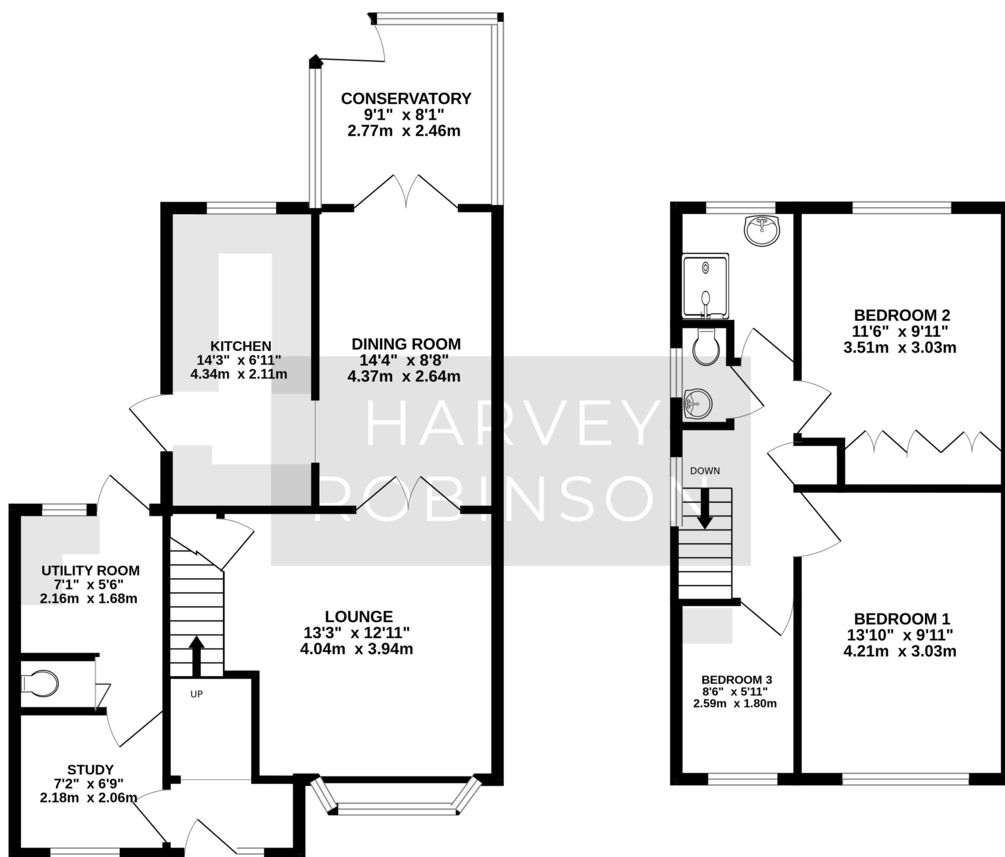

## FAQs

Postcode for SatNav: PE19 7JT

What3Words location:

///cement.laminated.self

How long have the owners lived here: Since 2017

Vendors onward movements: Not buying on, moving in with family

Council tax: D

Garden aspect: S/W

Boundary fence responsibility: Left

Water meter: Yes

Loft: Part boarded

Boiler serviced: 2024

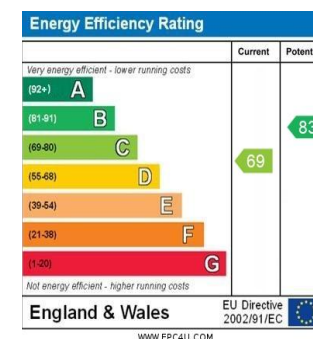

Agents Note: Whilst every care has been taken to prepare these particulars, they are for guidance purposes only. All measurements are approximate and are for general guidance purposes only and whilst every care has been taken to ensure their accuracy, they should not be relied upon and potential buyers/tenants are advised to recheck the measurements

HARVEY ROBINSON

### OFFICE ADDRESS

22 Market Square, St Neots,  
Cambridgeshire, PE19 2AF

### CONTACT

01480 454040  
stneots@harveyrobinson.co.uk  
www.harveyrobinson.co.uk