



HARVEY ROBINSON

Offers In Excess Of
£600,000
High Street
Graveley, PE19 6PL

PROPERTY SUMMARY

Harvey Robinson estate agents in St Neots are delighted to be marketing this rarely available, versatile family home that has fantastic annexe potential or could make an ideal multi-generational home. In total the property boasts seven bedrooms, three bathrooms/en-suite, three reception rooms, and two kitchen areas plus a utility room.





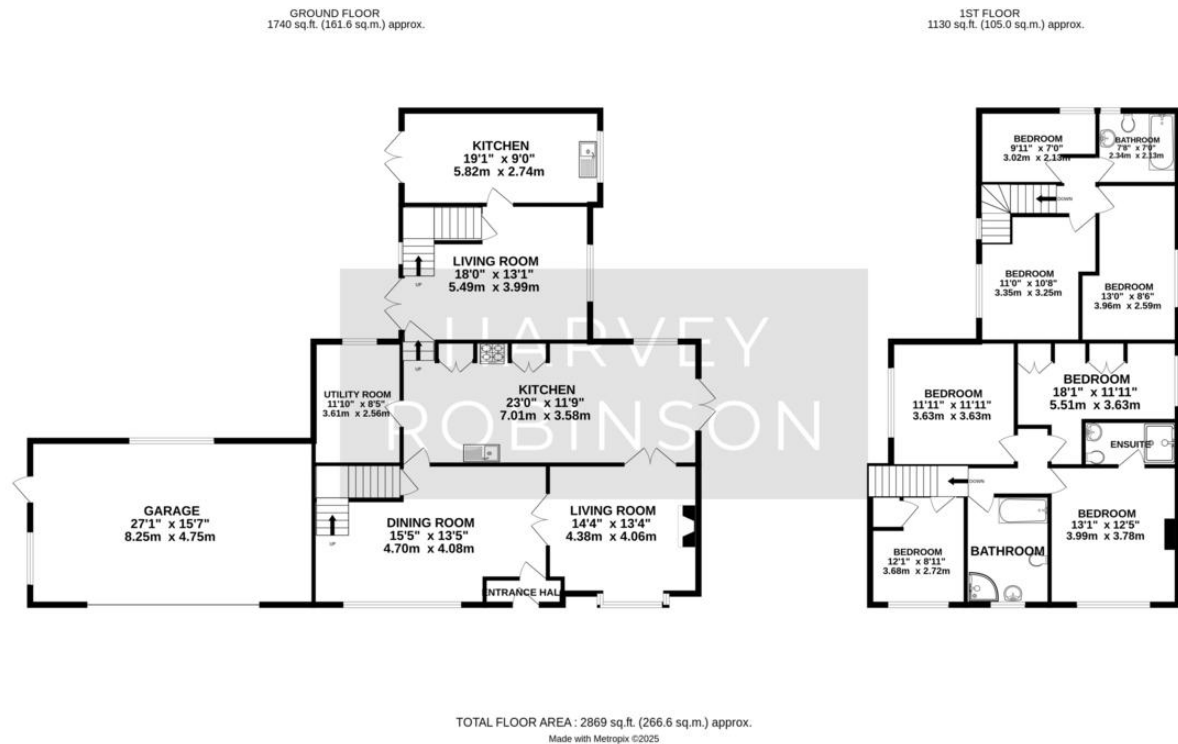

FAQs

Postcode for SatNav: PE 19 6PL

What3Words Location:

///scouting.segments.ringside

How long has the vendor owned the property: 19 years

Vendors onward movements: This property is end of chain

Council tax: F

Boiler: There is one boiler in the house installed approx. 4 years ago and another in the potential annexe installed approx. 10 years ago

Loft: Part boarded with light and ladder fitted

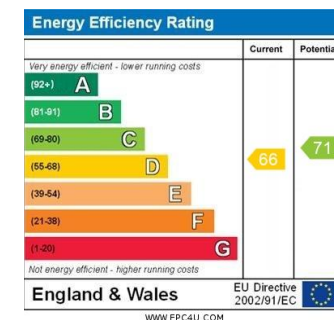

Agents Note: Whilst every care has been taken to prepare these particulars, they are for guidance purposes only. All measurements are approximate and are for general guidance purposes only and whilst every care has been taken to ensure their accuracy, they should not be relied upon and potential buyers/tenants are advised to recheck the measurements

HARVEY ROBINSON

OFFICE ADDRESS

22 Market Square, St Neots,
Cambridgeshire, PE19 2AF

CONTACT

01480 454040
stneots@harveyrobinson.co.uk
www.harveyrobinson.co.uk