



HARVEY ROBINSON

£375,000
Cornwall Court
Eaton Socon, PE19 8PR

PROPERTY SUMMARY

Harvey Robinson estate agents in St Neots are delighted to be marketing this three bedroom link detached home, ideally located within a desirable cul-de-sac location. The accommodation comprises of an entrance porch, lounge, kitchen, dining room, cloakroom, and conservatory to the ground floor. To the first floor there are three bedrooms, and a family bathroom. The property further benefits from driveway parking to the front, a garage, and a rear garden. Please contact our St Neots branch to arrange a viewing.





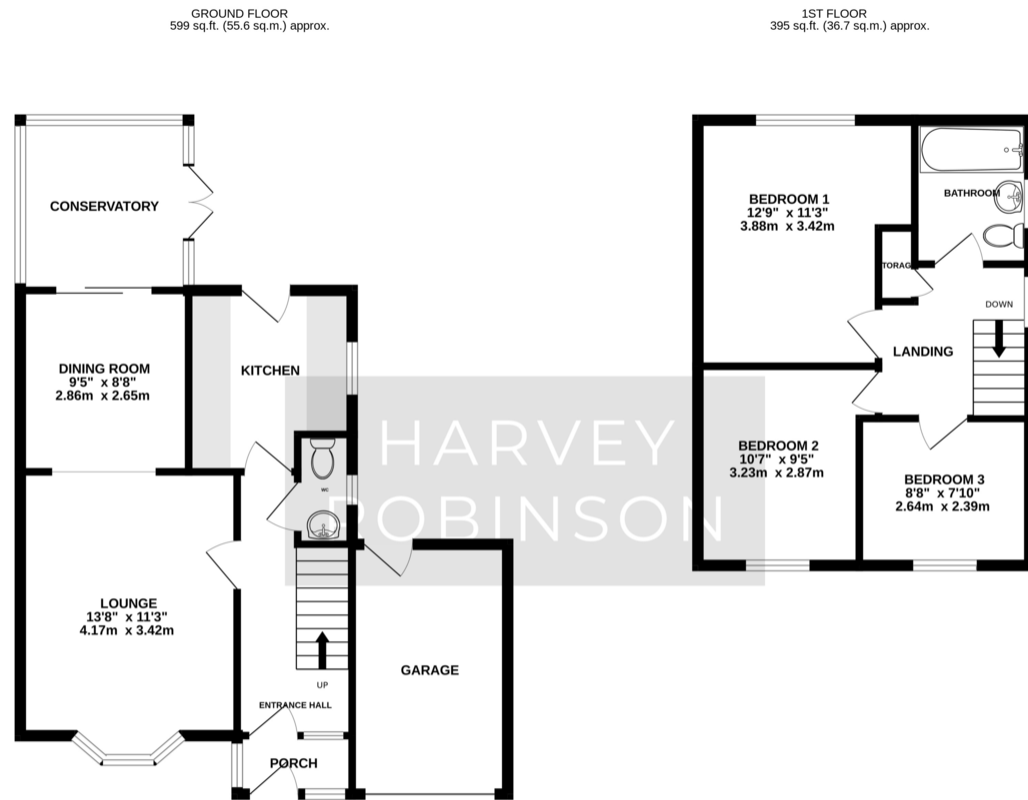

TOTAL FLOOR AREA: 994 sq.ft. (92.3 sq.m.) approx.
Made with Metropix ©2025

FAQs

Postcode for SatNav: PE19 8PR

What3words Location:

///reactions.roost.cherry

Property Built: 1983

Windows: Replaced in 2021

Conservatory: Built 2008

Council tax: C

Garden aspect: North

How long have the owners lived here: 24 years, selling due to separation, Mrs will be buying on and needs to find

Boiler: 2006, serviced Jan '25

Primary School Catchment: Crosshall

Secondary School Catchment: Longsands

Agents Note: Whilst every care has been taken to prepare these particulars, they are for guidance purposes only. All measurements are approximate and are for general guidance purposes only and whilst every care has been taken to ensure their accuracy, they should not be relied upon and potential buyers/tenants are advised to recheck the measurements

HARVEY ROBINSON

OFFICE ADDRESS

22 Market Square, St Neots,
Cambridgeshire, PE19 2AF

CONTACT

01480 454040
stneots@harveyrobinson.co.uk
www.harveyrobinson.co.uk