



HARVEY ROBINSON

Offers In Excess Of
£325,000

Linton Close
Eaton Socon, PE19 8GY

PROPERTY SUMMARY

Harvey Robinson estate agents in St Neots are delighted to be marketing this spacious four-bedroom townhouse in Eaton Socon. The property benefits from a refitted kitchen, which has been opened up to create a spacious open-plan living area, with French doors leading out to the South facing garden. There is also a hallway and cloakroom to the ground floor. To the first floor there are two double bedrooms and a refitted bathroom, on the second floor there are two further bedrooms, one of which is the master bedroom which boasts an en-suite, and ample storage in a range of fitted wardrobes. Outside, there is an enclosed rear garden, with trees to the rear which provide a good amount of privacy. There is also an allocated parking space to the front, and various visitor spaces surrounding.





GROUND FLOOR
367 sq.ft. (34.1 sq.m.) approx.



1ST FLOOR
388 sq.ft. (36.1 sq.m.) approx.

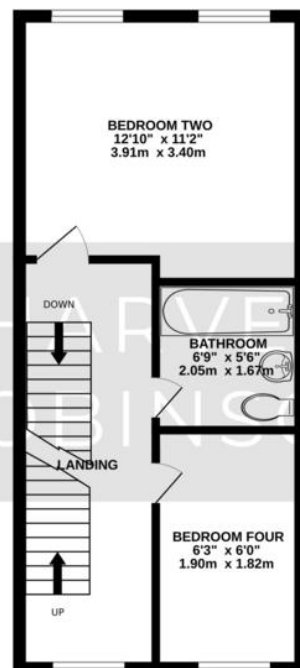

2ND FLOOR
388 sq.ft. (36.1 sq.m.) approx.

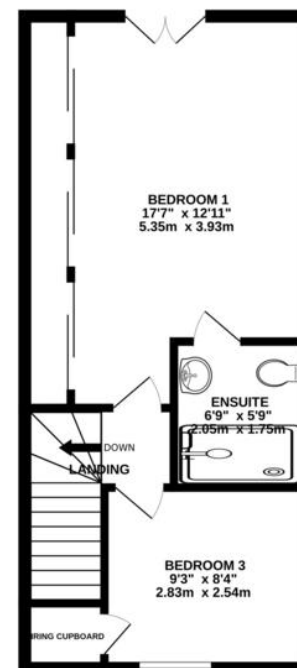

TOTAL FLOOR AREA : 1144 sq.ft. (106.3 sq.m.) approx.
Made with Metropix ©2025

FAQs

Postcode for SatNav: PE19 8GY

What3words Location:

///storeroom.exotic.slings

Council Tax: D

Rear Garden Aspect: South

Boiler: Installed 2024

Loft: Boarded

Estate Maintenance Charge: £400 per annum

How long have the owners lived here: 5 years

Primary School Catchment: Bushmead

Secondary School Catchment: Ernulf

Score	Energy rating	Current	Potential
92+	A		
81-91	B		89 B
69-80	C	78 C	
55-68	D		
39-54	E		
21-38	F		

Agents Note: Whilst every care has been taken to prepare these particulars, they are for guidance purposes only. All measurements are approximate and are for general guidance purposes only and whilst every care has been taken to ensure their accuracy, they should not be relied upon and potential buyers/tenants are advised to recheck the measurements

HARVEY ROBINSON

OFFICE ADDRESS

22 Market Square, St Neots,
Cambridgeshire, PE19 2AF

CONTACT

01480 454040
stneots@harveyrobinson.co.uk
www.harveyrobinson.co.uk