

A photograph of a two-story brick house with a dark grey tiled roof and a dormer window. The house has white-framed windows and doors. A silver car is parked in a paved driveway to the left. In the background, there are blue and green recycling bins. The house is surrounded by other brick buildings.

HARVEY ROBINSON

Offers In Excess Of
£340,000

Hendrey Place
Godmanchester, PE29 2NU

PROPERTY SUMMARY

Harvey Robinson Estate Agents in Huntingdon are delighted to present this beautifully presented three-bedroom semi-detached home, situated on Hendrey Place within the sought-after Romans Edge development in Godmanchester. Offering over 900 sq ft of accommodation arranged across three floors, this property makes an ideal purchase for first-time buyers or young families.





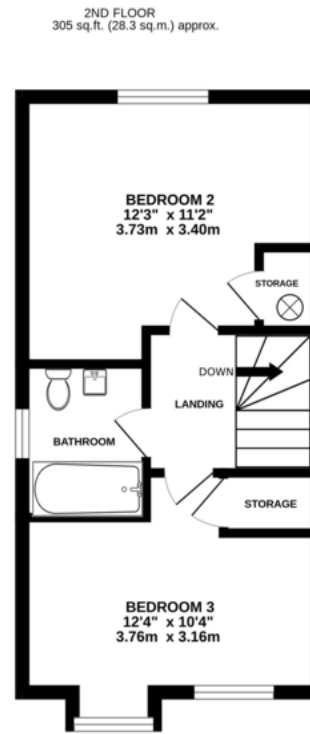
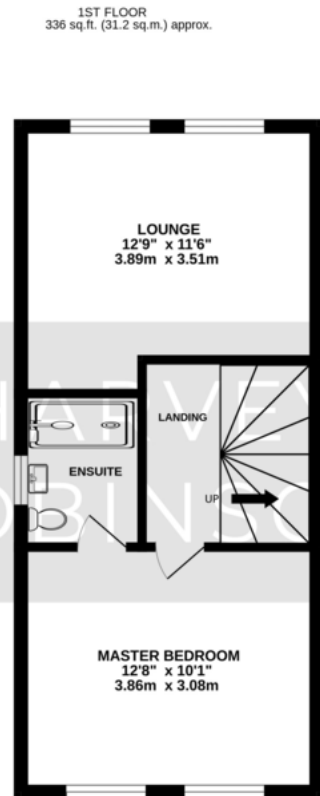
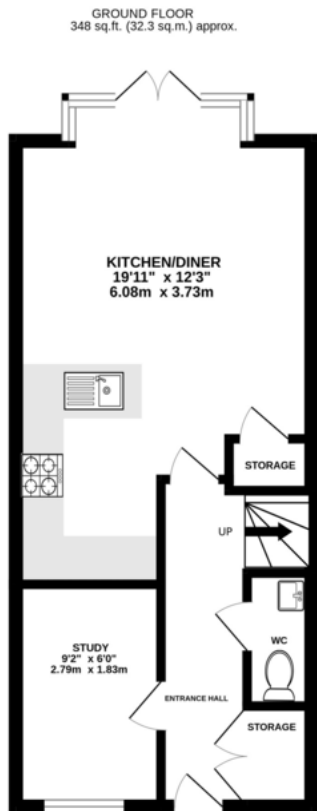

TOTAL FLOOR AREA : 989 sq.ft. (91.9 sq.m.) approx.
Made with Metropix ©2025

FAQs

Tenure: Freehold
Council Tax Band: D
Primary School Catchment: Bridge Academy
Secondary School Catchment: Hinchinbooke
Vendors Onward Movements: No chain
Property Built: 2018 - Vendors owned since Dec 2022
Loft: Part Boarded
Boiler and Windows: 2018 (Boiler Last serviced 2025)
Driveway has an POD point for an electric car

Score	Energy rating	Current	Potential
92+	A		95 A
81-91	B	85 B	
69-80	C		
55-68	D		
39-54	E		
21-38	F		
1-20	G		

Agents Note: Whilst every care has been taken to prepare these particulars, they are for guidance purposes only. All measurements are approximate and are for general guidance purposes only and whilst every care has been taken to ensure their accuracy, they should not be relied upon and potential buyers/tenants are advised to recheck the measurements

HARVEY ROBINSON

OFFICE ADDRESS

91 High Street, Huntingdon,
Cambridgeshire, PE29 3DP

CONTACT

01480 454040
huntingdon@harveyrobinson.co.uk
www.harveyrobinson.co.uk